

**NEW TECHNOLOGY**

**Giben<sup>®</sup>**

formula X



**PDM**  
**SYSTEM**

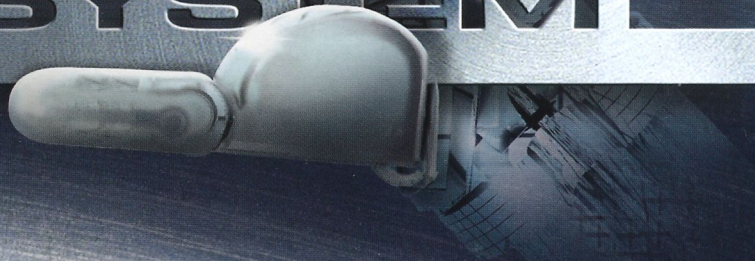

GB USA

## Giben <sup>G-Drive<sup>RT</sup></sup> formula X

**GIBEN FormulaX SPT**  
panel saw equipped with  
**PM System** controlling the  
position of grippers along  
the width of the pusher  
(X axis).

The new series **GIBEN FormulaX** represents the most advanced technology in panel sizing. Its look, its technical features and the technical innovation **PM System** make it truly unique. **PM System** is the innovative system of moving grippers using computer controlled positioning, integrated in a process of high automation to add the maximum flexibility to the production environment. In practice the machine becomes a universal machine managed by the **G-Drive<sup>RT</sup>** control system which automatically adjusts for the dimensions of the boards and the strips to be cut in every moment.

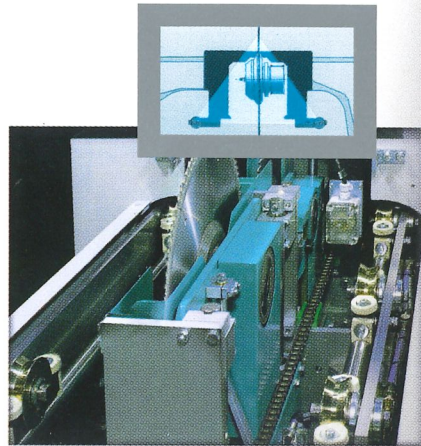
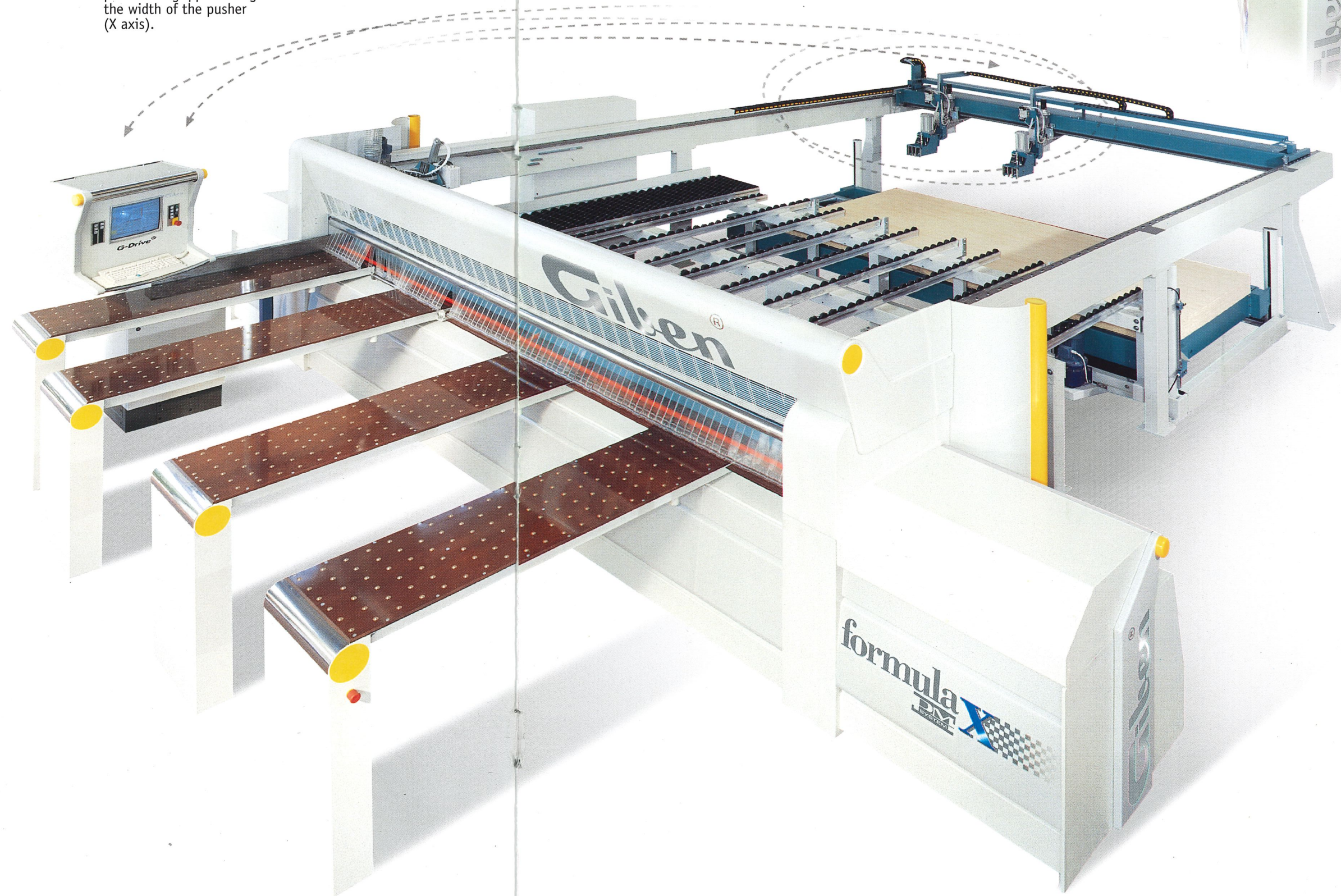

**Saw carriage** and "triangle shaped" guiding system that has been in use for more than 30 years on all GIBEN machines, guaranteeing sturdiness and maximum stability.

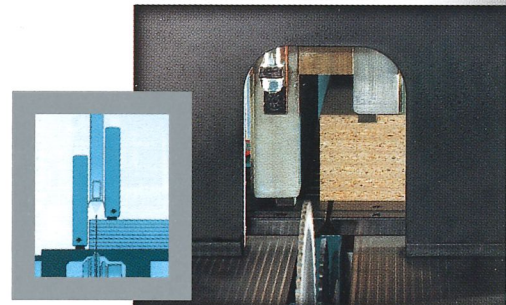

**Split and independent pressure beam.**  
Besides blocking the stack and applying equal pressure even during the last trim cut, the beam guarantees optimum dust extraction.

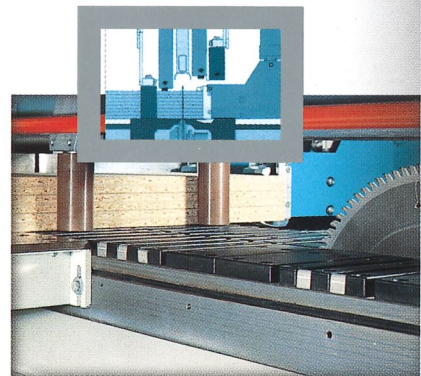

**Automatic side aligning.**  
This device keeps the stack of strips constantly aligned during the forward and reverse movement of the pusher and during the whole cross cutting cycle until the last trim cut.



**New system of moving grippers with automatic positioning.**

**PM System** makes the panel saw suitable to work with panels or groups of strips of any size. Its basic tools, the grippers, have been made adaptable to different formats and to the type of different panels or groups of strips. The gripper has been conceived as a robotized device, controllable in its movements along the width of the pusher (X axis).

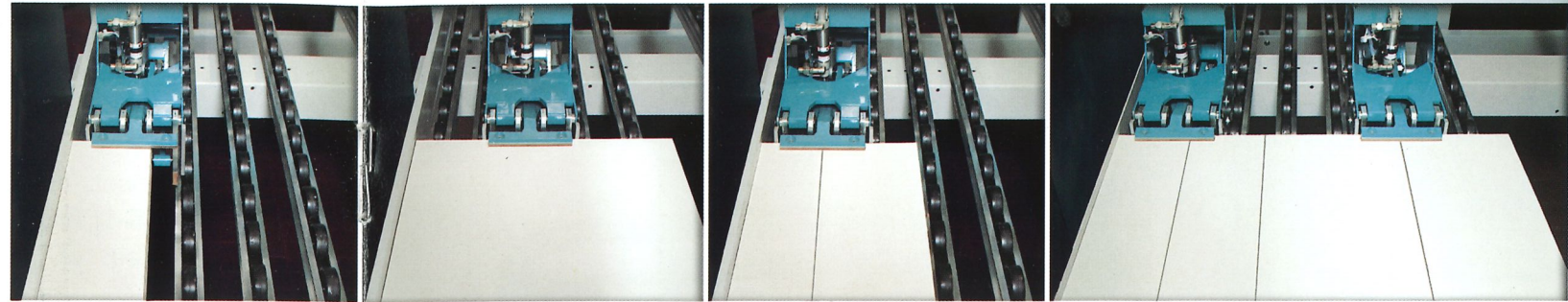

With the solution of **controlled positioning by G-Drive**®, it is possible to secure, with just a few grippers, a positive grip for several panels side by side, bound to be sized and moved together.

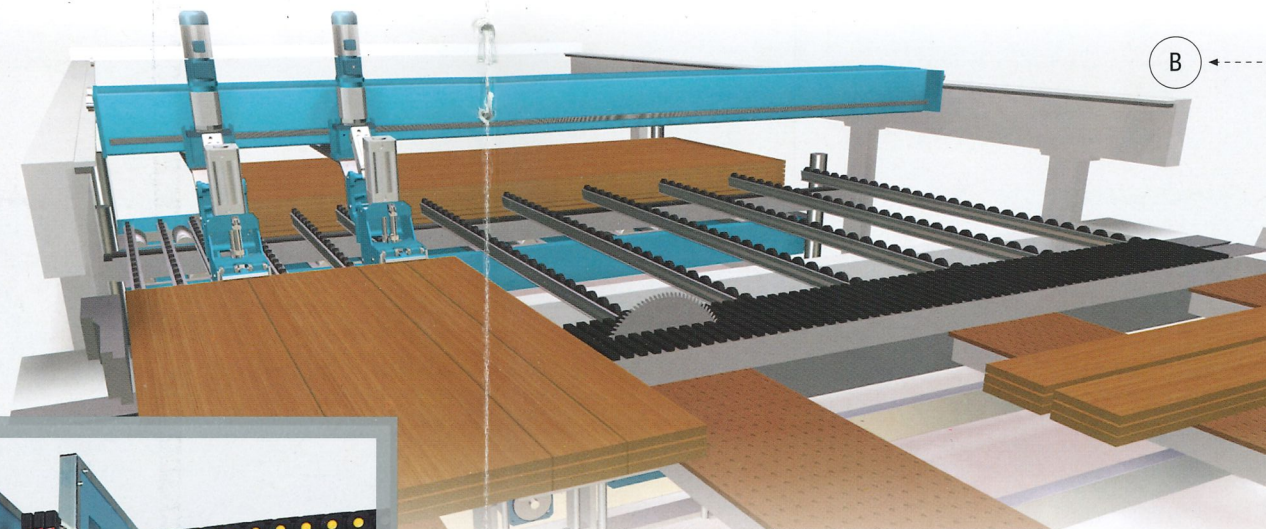
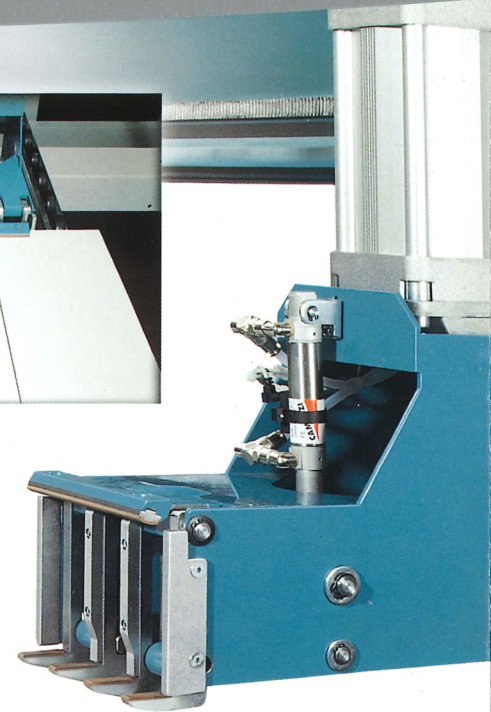

The **PM System** allows to always optimize the grip of the grippers based on the actual dimension of the panels (picture A) or of the groups of strips to be cut (picture B).

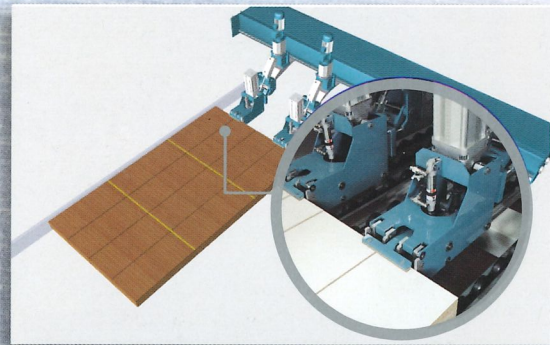

The **PM System** allows avoiding the inconvenient position of a gripper pinching the corner of a stack, a situation leading to the damage of an edge already cut and finished.

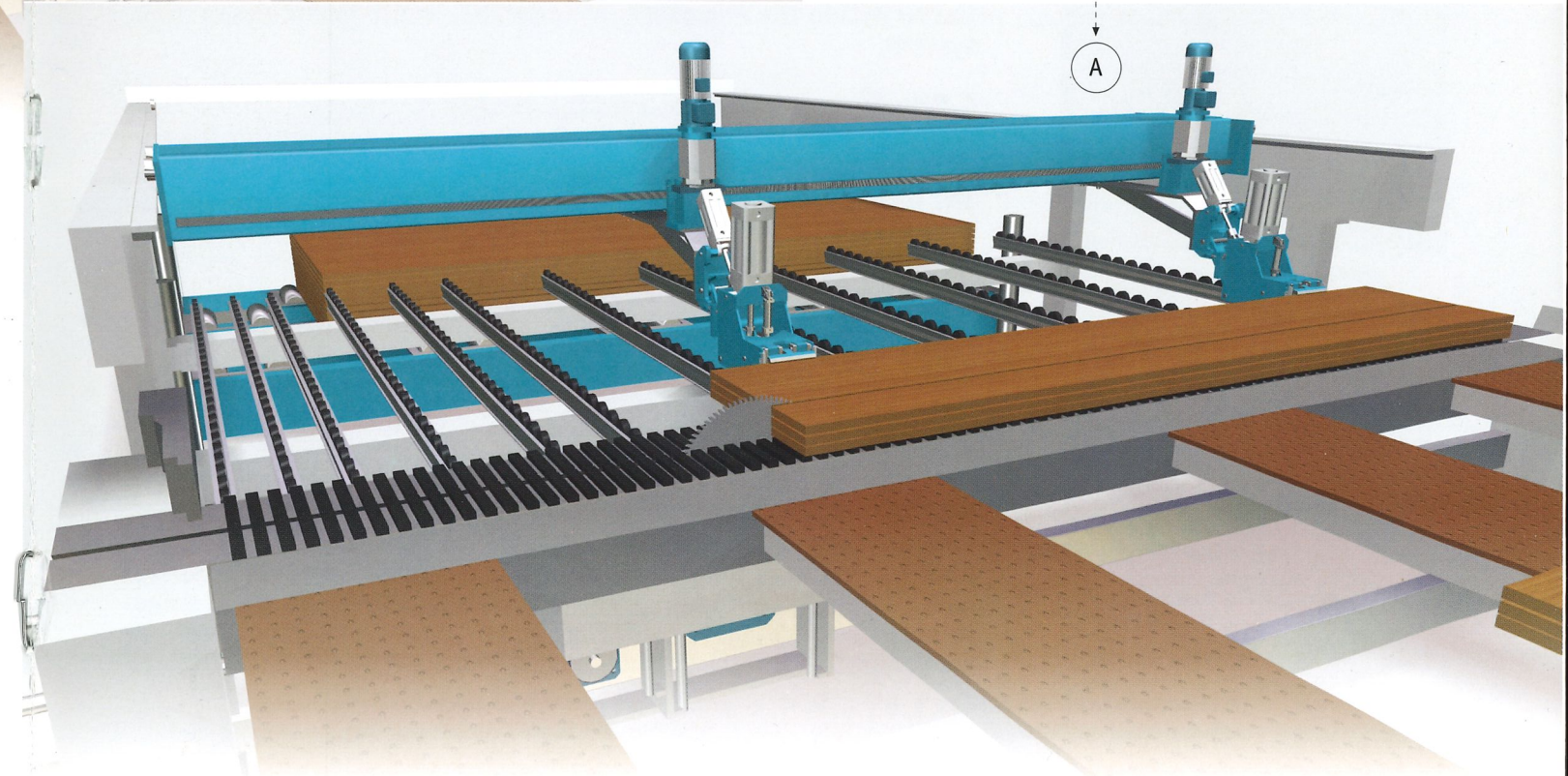
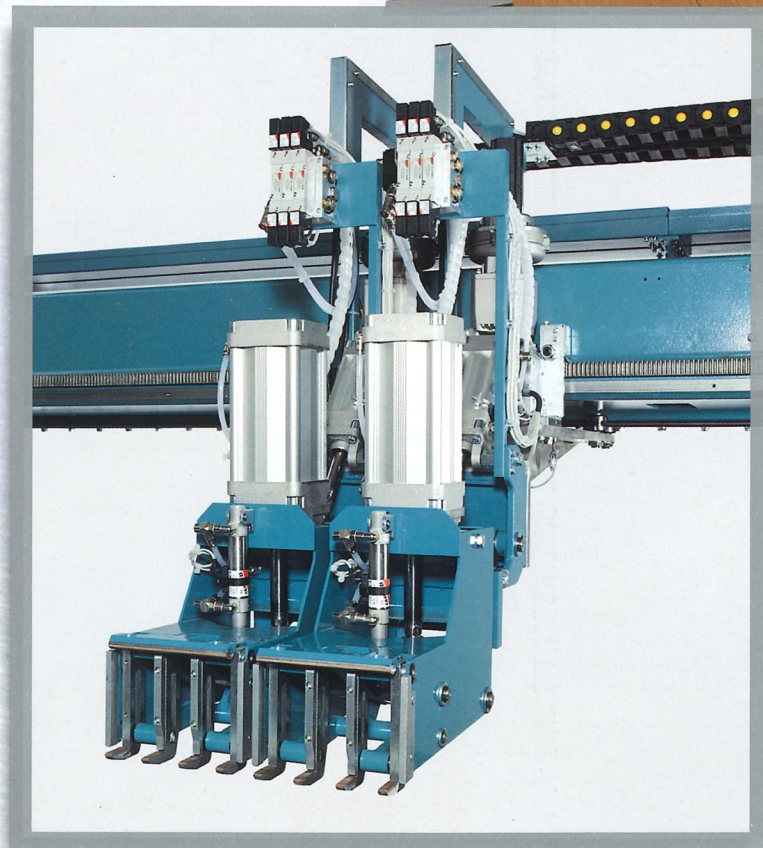



**NEW TECHNOLOGY**

**A ROBOT... FOR PARTNER!**

**Giben**<sup>®</sup>

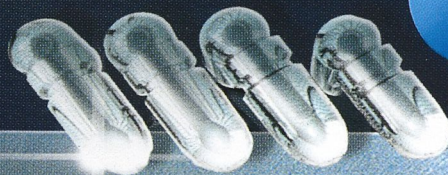

**PM**  
**SYSTEM**



GIBEN PM SYSTEM ADVANTAGES

• **Higher productivity**

It is possible to cross cut more strips side by side without the need to add any fixed additional grippers, because the grippers are always placed in a optimal position for the cutting pattern in execution.

• **More logical machine cycles**

The moving grippers with automatic positioning group more strips together allowing a more logical material handling.

• **Optimization without limitation**

There is no limitation as to the patterns that the machine can process, because the "danger" areas of fixed position grippers have been eliminated by the **PM System**. Cutting of rests even of small size is always optimised.

• **No damage to the corners of the panels**

Panels often suffer the problems of corner damage due to fixed position grippers. This problem is fully removed by **PM System**, as it allows a proper positioning of the grippers in relation to the changing dimensions of panels and cutting patterns.

• **Fewer number of saw carriage and pusher movements**

As more strips can be placed side by side this translates into a fewer number of cycles and movements of saw carriage and pusher.

• **Long term solution**

There is no need to replace or modify the machine as the panel format needs change. **PM System** is the solution which allows the machine to meet the needs of today and tomorrow.

With the solution of  
secure, with just a few  
bo

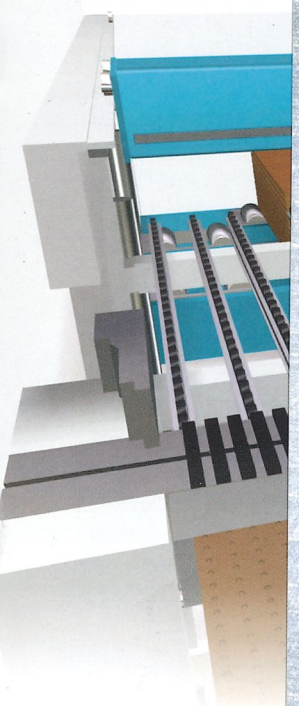
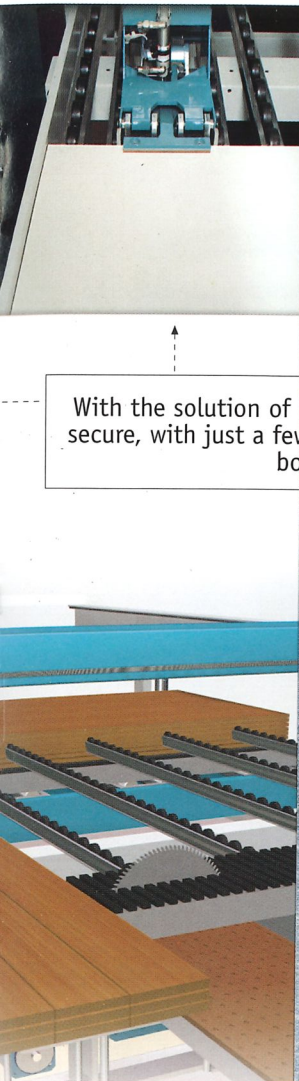

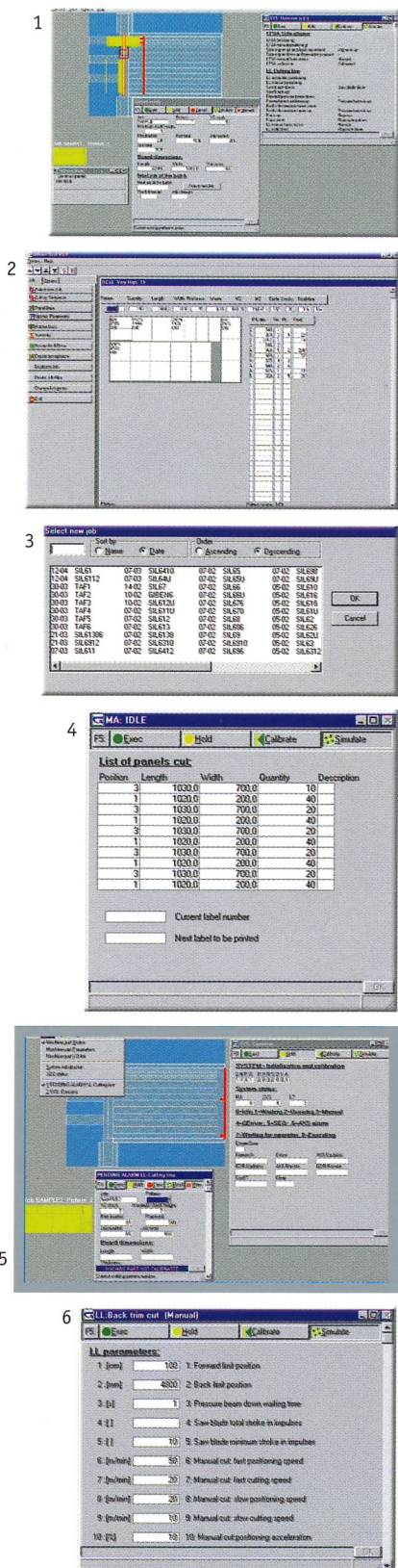

- 1 - Real-time graphic of various operation phases.
- 2 - Pattern graphics shown on scale.
- 3 - Jobs library.
- 4 - By-pattern summary of parts cut.
- 5 - Menu selection.
- 6 - Modifications of user defined parameters.

Easy access to the control panel. The control pad and the electronic programmer are positioned on a monitor on the left side of the machine. The monitor can rotate 180°.



**G-Drive<sup>RT</sup> machine control software has been developed by GIBEN to run within the Microsoft<sup>®</sup> Windows NT<sup>™</sup> multi-tasking operating system.**

**G-Drive<sup>RT</sup> controls all the machine movements directly.** The machine layout and cutting patterns are displayed, to scale, on the screen. During job execution or simulation mode, all machine operations, and panels and parts movements are displayed on the screen in real time. Direct control by **G-Drive<sup>RT</sup>** of all the machine functions facilitates the ultimate in diagnostic and troubleshooting, enabling fast and efficient problem solving. This is achieved, from the operator's perspective, by a combination of detailed error message descriptions, suggested help solutions, short video help sequences, photographs, and drawings. Furthermore, the Windows NT<sup>™</sup> operating system allows the easy editing and/or upgrading of the diagnostic system library as necessary.

The input of data is made simple in a number of different ways, manually at the machine, by floppy disk or via a network. Dynamic label printing, as the parts are being cut, is also available. All of the above is installed on the machine controller, which is a standard office type PC equipped with a 17" color screen. The main three elements making up the controller i.e. keyboard, computer and screen are completely interchangeable with their counterparts in the office.

# formula X

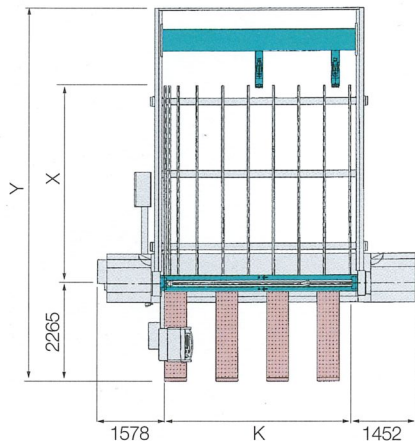

**FormulaX SP**

K	X	Y
3800	3350	7450
	4100	8200
4500	4100	8200
	4550	8650

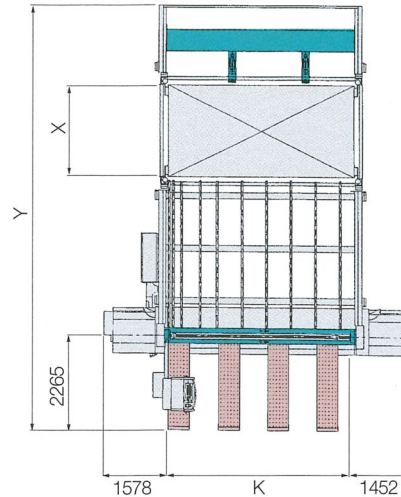

**FormulaX SPT**

K	X	Y
3800	1600	8950
	2200	9450
4500	1600	8950
	2200	10250

Technical specifications	FormulaX	
	Hz 50	Hz60
Saw projection	132 mm	5,2"
Saw carriage • feed speed • return speed	1+130 m/min. 130 m/min.	3+427 ft/min. 427 ft/min.
Main saw • motor	Ø 470 mm. 15 - (18) kW	Ø 18,5" 18 - (22) kW
Scoring saw • motor	Ø 215 mm. 2,2 kW	Ø 8,4" 2,6 kW
Pusher speed • fast feed (*) • return (*)	1+60/min. 60 m/min.	3+197 ft/min. 197 ft/min.
Dust extraction • air speed • dust extraction outlets	30+35 m/sec. Ø 200 mm Ø 115 mm	98+115 ft/sec. Ø 7,8" Ø 4,5"
Compressed air • pressure • consumption	5+6 bar 20+30 l/min.	5+6 bar 20+30 l/min.

(\*) The feed speed of the pusher can be modified. The value stated above corresponds to a parametric data set during running tests. The data may vary country by country in relation to safety requirements.



**FormulaX** is equipped with devices which ensure that European safety standards (CE mark) are respected completely. In order to meet European safety standards the machine must be supplied with safety guards.

MACHINES AND TECHNICAL DATA MAY VARY COUNTRY BY COUNTRY IN RELATION TO SAFETY REQUIREMENTS.

TECHNICAL DATA AND MACHINE CONFIGURATIONS MAY VARY. GIBEN RESERVES THE RIGHT TO MAKE MODIFICATIONS TO THE DATA AND TO THE REPRESENTATIONS MADE IN THIS BROCHURE AT ANY TIME AND WITHOUT PRIOR NOTICE.

# Giben®

IN THE WORLD

**GIBENAMERICA** INC.  
PANEL SIZING MACHINES AND SYSTEMS  
NORCROSS, GA 30071 - USA  
Ph. 770-448-9140 - Fax 770-448-9133

**GIBENAUSTRALIA** PTY.LTD  
PANEL SAWS AND ANGULAR SYSTEMS  
SOMERTON PARK SA 5044-AUSTRALIA  
Ph. 08-8358-0011 - Fax 08-8358-0022

**GIBENdoBRASIL**  
MAQUINAS E EQUIPAMENTOS LTDA.  
CEP. 81450-080 CURITIBA - PR - BRASIL  
Ph. 041-3471030 - Fax 041-3471121

**GIBENCANADA** INC.  
PANEL SIZING MACHINES AND SYSTEMS  
WEIR, QUÉBEC CANADA, J0T 2V0  
Ph. 819-687-3234 - Fax 819-687-8466

**GIBENDEUTSCHLAND** GmbH.  
MASCHINEN UND ANLAGEN  
ZUM AUFTEILEN VON PLATTEN  
D - 72186 EMPFINGEN  
Ph. 07485-99803-0 - Fax 07485-99803-23

**GIBENdeESPAÑA** S.A.  
MÁQUINAS E INSTALACIONES PARA SECCIONAR  
08015 BARCELONA - ESPAÑA  
Ph. 93-4237993 - Fax 93-4260469

**GIBENSCANDINAVIA** A.S.  
MASKINER OG ANLÆG FOR TRÆINDUSTRIEN  
DK-5260 ODENSE S - DENMARK  
Ph. 0045-65-958262 - Fax 0045-65-959449

**GIBEN U.K.** LIMITED  
PANEL SAWS AND ANGULAR SYSTEMS  
NG7 2NN - NOTTINGHAM  
Ph. 0115-986-2150 - Fax 0115-986-2159

HEAD OFFICE:

**GIBENIMPIANTI** S.p.A.  
PANEL SIZING MACHINES AND SYSTEMS  
40065 PIANORO - BOLOGNA - ITALIA  
Ph. +39-0516516400 - Fax +39-0516516425  
E-mail: gibenimpianti@giben.it

[www.giben.it](http://www.giben.it)  
[www.giben.com](http://www.giben.com)